

Assignment 1: The Double Diamond Design Process

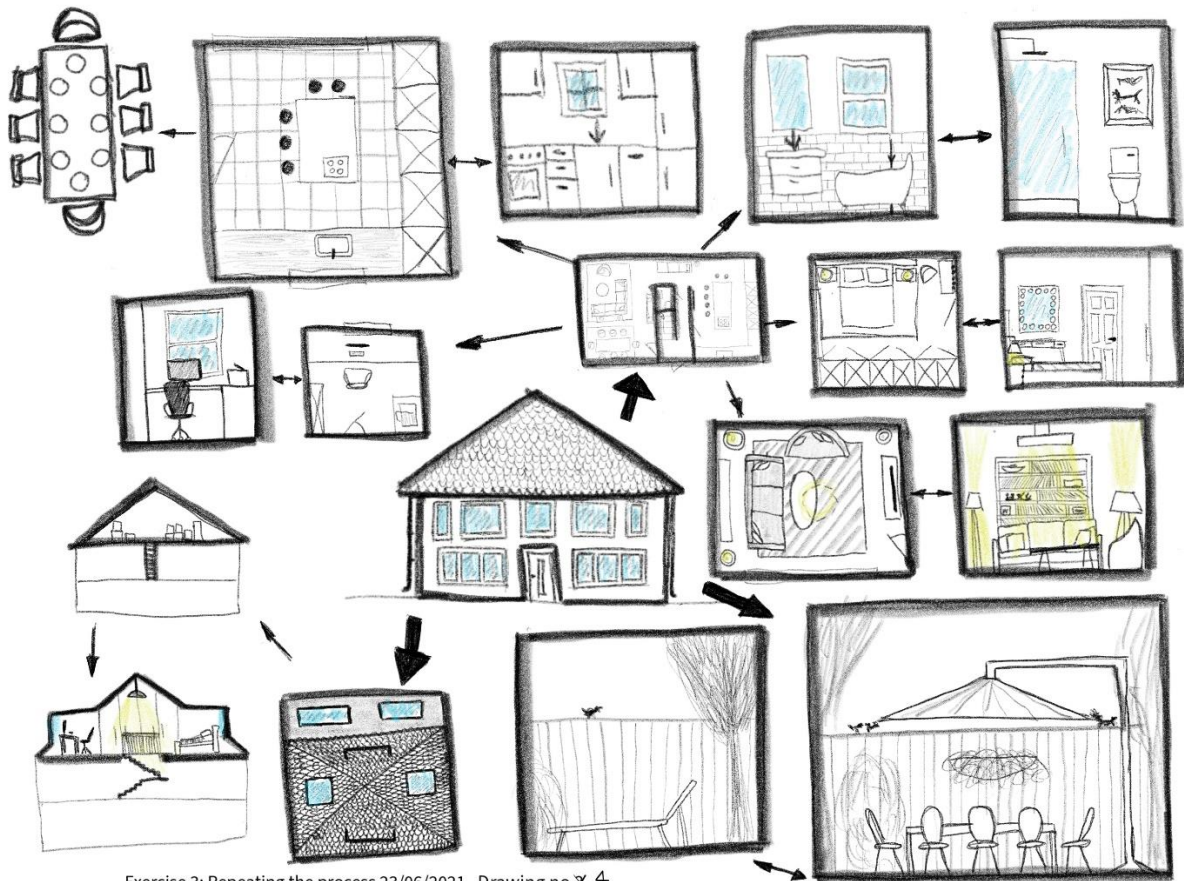

My creative design process is looping back and forth through different stages. I redrew my initial process to get me started. After drawing the lines through different stages I switched off the pink layer and saw a very abstract gorilla portrait. Perhaps one of my models could act as an animal enclosure.





Exercise 3: Repeating the process 23/06/2021 Drawing no X 4

The house, as a building contains rooms, and these rooms contain elements that make it a home. A house would usually have a garden. A garden again would have elements to make it usable and part of a home. Here in my design process of this mind map I initially created it in black and white. Later on, I added some colour to indicate lamp light and glass.

This sort of house would easily suit my client and her family. Large kitchen/diner, cosy lounge, loft extension and garden with a space to dine and relax would all suit a modern family.

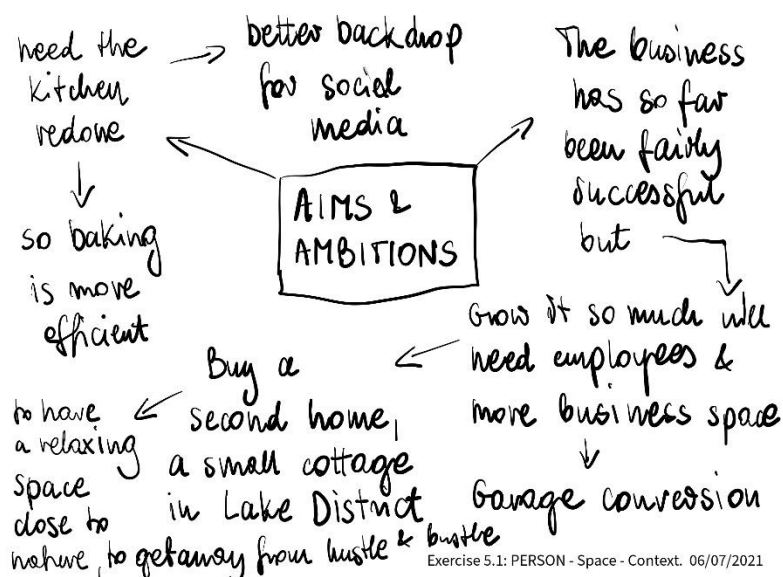

Exercise 5.1: PERSON - Space - Context. 06/07/2021

My client is a baker, and my model can hardly act as a garage converted into a bigger kitchen. However, what it could be, after combining two models is a cake stand with a beautiful cake on top.

